

## imageRUNNER ADVANCE DX 4700 Series

Print up to 51 ppm (BW)

Scan up to 270 (300 dpi) (BW/color, duplex)

Print up to 11" × 17"

6,350-sheet maximum paper capacity

Canon's comprehensive portfolio of imageRUNNER ADVANCE multifunction printers and integrated solutions can help **simplify** the end user experience and management of technology; better **control** sensitive information and print-related costs; and help ensure that technology investments proactively **evolve** with changing needs.

Black-and-white  
Mid-volume  
Multifunction



### WORKFLOW EFFICIENCY

- 10.1" intuitive touchscreen with smartphone-like usability.
- A unique, customized experience tailored to individual preferences using My ADVANCE.
- Supports mobile solutions and integration with many popular cloud services like Google Drive.<sup>1</sup>
- Scan and convert documents to searchable digital files in a variety of file formats.
- Integration with Canon and various third-party software with embedded application platform.
- Hot Folders allow users to drag and drop a file into a hot folder, and automatically print with predefined settings such as number of copies and finishing requirements.



### SECURITY

- Advanced standard security feature set to help safeguard sensitive information and assist in regulatory compliance.
- Integrates with existing, third-party SIEM\* systems to help provide real-time, comprehensive insights into potential threats to the network and printers.
- Technology to verify that the device boot process, firmware, and applications initialize without alteration at startup. McAfee Embedded Control<sup>2</sup> utilizes a whitelist to protect against malware and tampering of firmware and applications.
- Security policy settings can be controlled with a dedicated password, configured from a central location, and exported to other supported devices.
- Control access to the device and specific features, using a host of flexible authentication methods—PIN code, user name/password, or card access.<sup>3</sup>



### QUALITY AND RELIABILITY

- Canon's signature reliability and engine technologies help keep productivity high and minimize the impact on support resources.
- Outstanding imaging technologies and toner allow for crisp text and consistent images in rich black-and-white tones.
- Designed to achieve maximum uptime with status notifications to help keep supplies replenished and intuitive maintenance videos for consumables replacement.
- imageRUNNER ADVANCE DX models have received many awards and recognition from leading industry analysts, often referencing strong reliability.



## DEVICE AND FLEET MANAGEMENT

- Designed for quick, easy deployment.
- Remote diagnostics and parts life management for proactive maintenance and rapid fixes.
- Easy and intuitive to monitor device status and consumable levels, turn off devices remotely, observe meter readings, manage settings, and implement security policies.
- Common firmware and regular updates with Unified Firmware Platform (UFP) for continuous improvements and consistency across a fleet.



## COST MANAGEMENT

- Track and assess print, copy, scan, and fax usage and allocate costs to departments or projects.
- Apply print policies and restrict usage by user to help reduce unnecessary printing and contribute to cost efficiency.
- Standard cloud-based solution provides a centralized dashboard with up-to-the-minute insights into printer activity.
- Upgrade to uniFLOW server or cloud-based solutions for full accounting and reporting for compatible Canon and third-party devices, pull printing, job routing, and powerful scan workflows.



## SUSTAINABILITY

- A combination of fusing technologies and low-melting-point toner minimizes power requirements and helps achieve low energy consumption.
- Encourage environmentally-conscious work practices by enabling multiple settings that can help save paper and energy.
- ENERGY STAR® certified and rated EPEAT® Gold.<sup>4</sup>

## CONFIGURATION OPTIONS

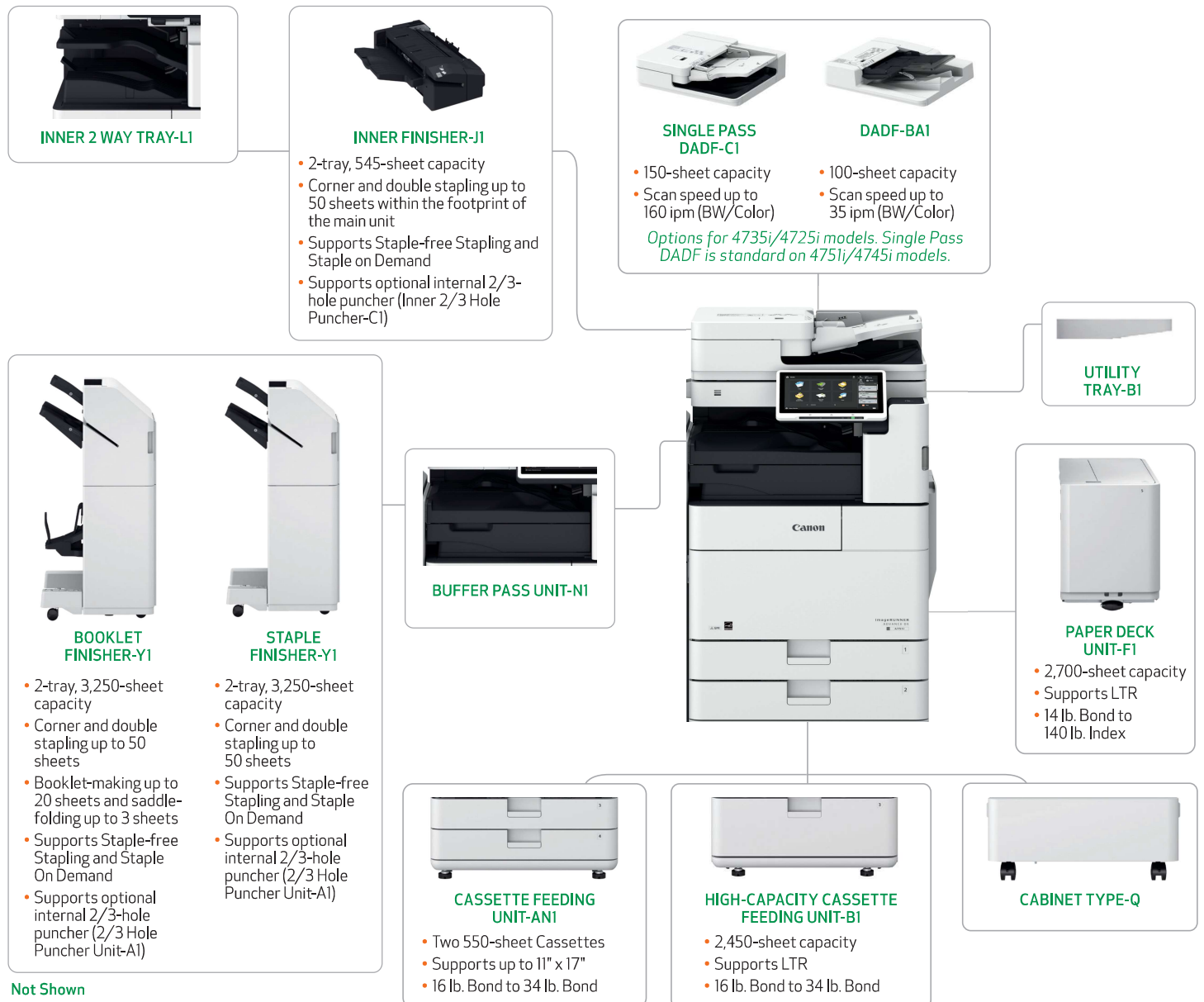

### Not Shown

- Inner 2/3 Hole Puncher-C1 (for Inner Finisher-J1)
- 2/3 Hole Puncher Unit-A1 (for External Finishers)
- Platen Cover Type-W

# SPECIFICATIONS

## Main Unit

### Type

Monochrome Laser Multifunctional

### Core Functions

Standard: Print, Copy, Scan, Send, Store  
Optional: Fax

### Processor

1.75 GHz Dual Core Processor

### Control Panel

10.1" TFT LCD WSVGA Color Touch-panel

### Memory

3.0 GB RAM

### Hard Disk Drive

Standard: 250 GB  
Maximum: 1 TB

### Print Resolution

1200 dpi x 1200 dpi

### Interface Connection

#### Network

Standard: 1000Base-T/100Base-TX/10Base-T,  
Wireless LAN (IEEE 802.11 b/g/n)

Optional: NFC, Bluetooth Low Energy

#### Others

Standard: USB 2.0 x1 (Host), USB 3.0 x1 (Host),  
USB 2.0 x1 (Device)

Optional: Copy Control Interface

### Paper Capacity (LTR, 20 lb. Bond)

Standard: 1,200 Sheets  
Maximum: 6,350 Sheets

### Paper Sources (LTR, 20 lb. Bond)

Standard: Two 550-sheet Paper Cassettes,  
100-sheet Stack Bypass

Optional: Two 550-sheet Paper Cassettes (Cassette  
Feeding Unit-ANI), 2,450-sheet Paper Deck  
(High Capacity Cassette Feeding Unit-B1),  
2,700-sheet Paper Deck (Paper Deck  
Unit-F1)

### Paper Output Capacity (LTR, 20 lb. Bond)

Standard: 250 Sheets  
3,350 Sheets (with Buffer Pass-N1 + Staple)

Maximum: Finisher-Y1 or Booklet Finisher-Y1

### Finishing Capabilities

Standard: Collate, Group  
With Finishers: Collate, Group, Offset, Staple, Saddle Stitch,  
Hole Punch, Eco Staple, Staple On Demand

### Supported Media Types

Upper/Lower Casette: Thin, Plain, Recycled, Color, Heavy,  
Pre-punched  
Multi-purpose Tray: Thin, Plain, Recycled, Color, Heavy,  
Pre-punched, Bond, Transparency,  
Label, Envelope

### Supported Media Sizes

Upper Cassette: Legal, Letter, Letter-R, Executive,  
Statement-R, Custom Size  
(5-1/2" x 7-1/8" to 11-3/4" x 15-3/8")  
Lower Cassette: 11" x 17", Legal, Letter, Letter-R, Executive,  
Statement-R, Custom Size  
(5-1/2" x 7-1/8" to 11-3/4" x 17"), Envelope<sup>5</sup>:  
[No.10 (COM10), Monarch, DL, ISO-C5]  
Multi-purpose Tray: 11" x 17", Legal, Letter, Letter-R, Executive,  
Statement-R, Envelope [No.10 (COM10),  
Monarch, DL, ISO-C5], Custom Size/Free  
Size (3-7/8" x 5-7/8" to 11-3/4" x 17")

### Supported Media Weights

Upper/Lower Cassette: 16 lb. Bond to 80 lb. Cover (60 to 220 g/m<sup>2</sup>)  
Multi-purpose Tray: 14 lb. Bond to 80 lb. Cover (52 to 220 g/m<sup>2</sup>)  
Duplexing: 16 lb. Bond to 28 lb. Bond (60 to 105 g/m<sup>2</sup>)

### Print/Copy Speed

4751i: Up to 51 ppm (Letter), Up to 37 ppm  
(Letter-R), Up to 25 ppm (Legal),  
Up to 25 ppm (11" x 17")  
4745i: Up to 45 ppm (Letter), Up to 32 ppm  
(Letter-R), Up to 25 ppm (Legal),  
Up to 22 ppm (11" x 17")  
4735i: Up to 35 ppm (Letter), Up to 32 ppm  
(Letter-R), Up to 25 ppm (Legal),  
Up to 22 ppm (11" x 17")  
4725i: Up to 25 ppm (Letter), Up to 17 ppm  
(Letter-R), Up to 13 ppm (Legal),  
Up to 15 ppm (11" x 17")

### Warm-up Time

From Power On: Approx. 24 Seconds<sup>6</sup>  
From Sleep Mode: Approx. 10 Seconds<sup>7</sup>  
Quick Startup Mode: Approx. 4 Seconds<sup>8</sup>

### Dimensions (W x D x H)

4751i/4745i: 24" x 28-1/2" x 36-3/4"  
(608 mm x 722 mm x 932 mm)<sup>9</sup>  
4735i/4725i: With Platen Cover-Y2: 24" x 28-1/8" x 32-3/8"  
(608 mm x 713 mm x 822 mm)  
With Single Pass DADF-C1: 24" x 28-1/2" x  
36-3/4" (608 mm x 722 mm x 932 mm)  
With DADF-BA1: 24" x 28-3/8" x 36-1/2"  
(608 mm x 719 mm x 926 mm)

### Installation Space (W x D)

Basic: 44" x 45-5/8" (1,116 x 1,160 mm) (with Platen  
Cover-Y2 + Multi-purpose Tray open/extension  
tray extended + Paper Cassette open)  
44" x 46" (1,116 x 1,169 mm) (with Single  
Pass DADF-C1 + Multi-purpose Tray open/  
extension tray extended + Paper Cassette  
open)  
44" x 45-7/8" (1,116 x 1,166 mm) (with DADF-  
BA1 + Multi-purpose tray open/extension  
tray extended + Paper Cassette open)  
71-3/8" x 46" (1,811 x 1,169 mm) (with Single  
Pass DADF-C1 + Paper Deck Unit-F1 + Booklet  
Finisher-Y1 with extension tray extended and  
Saddle unit drawn)  
71-3/8" x 45-7/8" (1,811 x 1,166 mm) (with  
DADF-BA1 + Paper Deck Unit F1 + Booklet  
Finisher-Y1 with extension tray extended and  
Saddle unit drawn)

### Weight<sup>10</sup>

4751i/4745i: Approx. 193.8 lb. (87.9 kg)  
With Platen Cover: Approx. 165.3 lb. (75 kg)  
With Single Pass DADF-I: Approx. 193.8 lb.  
(87.9 kg)  
4735i/4725i: With DADF-BA1: Approx. 179.5 lb

## Print Specifications

### Standard Page Description Languages

UFR II, PCL<sup>®</sup>6, Adobe<sup>®</sup> PS<sup>®</sup> 3

### Supported File Types for Direct Print

PDF, TIFF, JPEG, EPS, XPS

### Printing from Mobile Devices and Cloud-based Services

A range of standard and optional software and MEAP-based solutions (including AirPrint, Mopria, Google Cloud Print, Canon PRINT Business, and uniFLOW Online) are available to provide printing from mobile devices or internet-connected devices and cloud-based services depending on your requirements. Please contact your sales representative for further information.

### Fonts

PCL Fonts: 93 Roman, 10 Bitmap fonts, 2 OCR fonts,  
Andalé Mono WT J/K/S/T (Japanese,  
Korean, Simplified and Traditional Chinese),<sup>11</sup>  
Barcode Fonts<sup>12</sup>  
PS Fonts: 136 Roman

### Operating System<sup>13</sup>

UFR II/PS: Windows<sup>®</sup> 7/8.1/10/Server 2008/Server  
2008 R2/Server 2012/Server 2012 R2/  
Server 2016/Server 2019, Mac OS X (10.10  
or later)  
PCL: Windows<sup>®</sup> 7/8.1/10/Server 2008/Server  
2008 R2/Server 2012/Server 2012 R2/  
Server 2016/Server 2019  
PPD: Windows<sup>®</sup> 7/8.1/10, Mac OS X (10.9 or later)

## Copy Specifications

### First-Copy-Out Time (Letter)

4751i: As fast as 3.7 seconds  
4745i: As fast as 3.8 seconds  
4735i: As fast as 3.8 seconds  
4725i: As fast as 5.2 seconds

### Copy Resolution (dpi)

600 x 600

### Multiple Copies

Up to 9,999 Copies

### Copy Exposure

Automatic or Manual (9 Levels)

### Magnification

25%-400% (1% Increments)

### Preset Reduction/Enlargement

25%, 50%, 64%, 73%, 78%, 100%(1:1), 121%, 129%,  
200%, 400%

## Scan Specifications

### Type

4751i/4745i: Standard Single Pass Duplexing Automatic  
Document Feeder  
4735i/4725i: Optional Single Pass Duplexing Automatic  
Document Feeder, Duplexing Automatic  
Document Feeder, or Platen Cover

### Document Feeder Paper Capacity

Single Pass DADF: Up to 200 Sheets  
DADF: Up to 100 Sheets

### Document Feeder Supported Media Sizes

11" x 17", Legal, Letter, Letter-R, Statement, Statement-R

### Document Feeder Supported Media Weights

Single Pass DADF-C1  
Single-sided Scanning: 13.3 lb. Bond to 80 lb. Cover  
(50 to 220 g/m<sup>2</sup>)  
Double-sided Scanning: 13.3 lb. Bond to 80 lb. Cover (50 to 220 g/m<sup>2</sup>)  
DADF-BA1  
Single-sided Scanning: 13.3 lb. Bond to 34 lb. Bond (50 to 128 g/m<sup>2</sup>)  
(BW), 17 lb. Bond to 34 lb. Bond (64 to 128  
g/m<sup>2</sup>) (CL)  
Double-sided Scanning: 13.3 lb. Bond to 34 lb. Bond (50 to 128 g/m<sup>2</sup>)  
(BW), 17 lb. Bond to 34 lb. Bond (64 to 128  
g/m<sup>2</sup>) (CL)

### Platen Acceptable Originals

Sheet, Book, 3-Dimensional Objects

### Platen Supported Media Size

UP to 11-3/4" x 17" (297 mm x 431.8 mm)

### Pull Scan

Color Network ScanGear2 for both Twain and WIA  
Supported OS: Windows<sup>®</sup> 7/8.1/10/Server 2008/Server 2008  
R2/Server 2012/Server 2012 R2/Server 2016

### Scan Resolution (dpi)

Push: Up to 600 x 600  
Pull: Up to 600 x 600

### Scan to Mobile Devices and Cloud-based Services

A range of solutions is available to provide scanning to mobile devices and cloud-based services depending on your requirements.

### Scan Speed (Letter)

Single Pass DADF-C1  
Single-sided Scanning  
BW/Color: 135/135 (300 x 300 dpi, send)  
80/80 (600 x 600 dpi, copy)  
Double-sided Scanning  
BW/Color: 270/270 (300 x 300 dpi, send)  
60/90 (600 x 600 dpi, copy)

### DADF-BA1

Single-sided Scanning  
BW/Color: 70/70 (300 x 300 dpi, send)  
51/51 (600 x 600 dpi, copy)  
Double-sided Scanning  
BW/Color: 35/35 (300 x 300 dpi, send)  
25.5/25.5 (600 x 600 dpi, copy)

## Send Specifications

### Destination

Standard: E-mail/Internet FAX (SMTP), SMB 3.0, FTP, WebDAV, Mail Box  
Optional: Super G3 Fax, IP Fax

### Address Book

LDAP (2,000)/Local (1,600)/Speed dial (200)

### Send Resolution (dpi)

Push: Up to 600 x 600  
Pull: Up to 600 x 600

### Communication Protocol

File: FTP (TCP/IP), SMB 3.0 (TCP/IP), WebDAV  
Email: SMTP, POP3

### File Format

TIFF, JPEG, PDF (Compact, Searchable, Apply Policy, Optimize for Web, PDF/A-1b, Trace & Smooth, Encrypted, Device Signature, User Signature), XPS (Compact, Searchable, Device Signature, User Signature), Office Open XML (PowerPoint, Word)

## Fax Specifications (Optional)

### Maximum Number of Connection Lines

4

### Modem Speed

Super G3: 33.6 Kbps  
G3: 14.4 Kbps

### Compression Method

MH, MR, MMR, JBIG

### Resolution (dpi)

400 x 400, 200 x 400, 200 x 200, 200 x 100

### Sending/Recording Size

Statement-R to 11" x 17"

### Fax Memory

Up to 30,000 Pages (2,000 Jobs)

### Speed Dials

Max. 200

### Group Dials/Destinations

Max. 199 Dials

### Sequential Broadcast

Max. 256 Addresses

### Memory Backup

Yes

## Store Specifications

### Mail Box (Number Supported)

100 User In-boxes, 1 Memory RX In-box, 50 Confidential Fax In-boxes, 30,000 Maximum Pages Stored (2,000 Jobs Stored)

### Advanced Box

Communication Protocol: SMB or WebDAV Supported

Client PC: Windows (Windows 8.1/10)

Concurrent Connections (Max.)

SMB: 64

WebDAV: 3 (Active Sessions)

### Advanced Box Available Disk Space

Approx. 16 GB (Standard HDD)

Approx. 480 GB (With Optional 1 TB HDD)

### Memory Media

Standard: USB

## Security Specifications

### Authentication

Standard: Universal Login Manager, uniFLOW Online Express,<sup>14</sup> User Authentication, Department ID Authentication, Access Management System, Device and Function Level Log-in

Optional: uniFLOW

### Data

Standard: Trusted Platform Module (TPM), Hard Disk Password Lock, Hard Disk Drive Erase, Mail Box Password Protection, Hard Disk Drive Encryption (FIPS140-2 Validated), Verify System at Startup, McAfee Embedded Control<sup>15</sup>

Optional: Hard Disk Drive Mirroring, IEEE 2600.2 Common Criteria Certification, Data Loss Prevention (Requires uniFLOW)

### Network

Standard: Encrypted Secure Print, IP/Mac Address Filtering, IPsec, TLS Encrypted Communication (v1.0/1.1/1.2/1.3), SNMP v3.0, IEEE 802.1X, IPv6, SMTP Authentication, POP Authentication before SMTP, S/MIME, SIEM Integration

### Document

Standard: Secure Watermark, Secure Print, Forced Hold Printing, Adobe LiveCycle<sup>®</sup> Rights Management ES2.5 Integration, Encrypted PDF, Encrypted Secure Print, Device Signature, User Signature

## Environmental Specifications

### Operating Environment

Temperature: 50 to 86°F

Humidity: 20 to 80% RH (Relative Humidity)

### Power Requirements

110-127V, 60Hz, 10.4A

### Power Consumption

Maximum: Approx. 1,500 W

Standby: Approx. 39 W<sup>15</sup>

Sleep Mode: Approx. 0.9 W<sup>16</sup>

Typical Electricity Consumption (TEC) Rating<sup>17</sup>

4751i: 0.71 kWh

4745i: 0.62 kWh

4735i: 0.51 kWh

4725i: 0.34 kWh

### Standards

ENERGY STAR<sup>®</sup> Certified

Rated EPEAT<sup>®</sup> Gold<sup>4</sup>

## Consumables

### Toner

GPR-57 Toner BK

### Toner Yield (Estimated @ 6% Coverage)

Black: 42,100 Images

<sup>1</sup> Subscription to a third-party cloud service required. Subject to third-party cloud service provider's terms and conditions.

<sup>2</sup> Requires Unified Firmware Platform v3.9 or greater.

<sup>3</sup> Requires additional option.

<sup>4</sup> For current EPEAT rating (Gold/Silver/Bronze), please visit [www.epeat.net](http://www.epeat.net).

<sup>5</sup> Envelope Feeder Attachment-D1 is required.

<sup>6</sup> Time from device power-on, until copy ready (not print reservation).

<sup>7</sup> Time from exiting Sleep mode to when printing is operational.

<sup>8</sup> Time from device power on to when the copy icon appears and is enabled to operate on the touch panel display.

<sup>9</sup> Time from device power-on to when key orientations can be performed on the touch panel display.

<sup>10</sup> Includes toner.

<sup>11</sup> Requires the optional PCL International Font Set-A1.

<sup>12</sup> Requires the optional Barcode Printer Kit-D1.

<sup>13</sup> Other operating systems and environments including AS/400, UNIX, Linux and Citrix may be supported. Some of these solutions are chargeable. SAP Device Types are available via the SAP Market Place. For more information, contact your sales representative.

<sup>14</sup> No charge for this solution; however activation is required.

<sup>15</sup> Reference Value (measured one unit).

<sup>16</sup> 0.9 W sleep mode not available in all circumstances due to certain settings.

<sup>17</sup> Based on ENERGY STAR Product Specification for Imaging Equipment Version 3.0.

USA.CANON.COM/SIMPLYADVANCED



AirPrint and the AirPrint logo are trademarks of Apple Inc. Canon, imageRUNNER, imageWARE, imagePASS, and the GENUINE logo are registered trademarks or trademarks of Canon Inc. in the United States and may also be registered trademarks or trademarks in other countries. Canon products offer certain security features, yet many variables can impact the security of your devices and data. Canon does not warrant that use of its features will prevent security issues. Nothing herein should be construed as legal or regulatory advice concerning applicable laws; customers must have their own qualified counsel determine the feasibility of a solution as it relates to regulatory and statutory compliance. McAfee and the McAfee logo are trademarks of McAfee LLC in the US and/or other countries. All other referenced product names and marks are trademarks of their respective owners. All printer output images are simulated. All features presented in this brochure may not apply to all Series and/or products and may be optional; please check with your Canon Authorized Dealer for details. Products shown with optional accessories. Canon U.S.A. does not provide legal counsel or regulatory compliance consultancy, including without limitation, Sarbanes-Oxley, HIPAA, GLBA, Check 21 or the USA Patriot Act. Each customer must have its own qualified counsel determine the advisability of a particular solution as it relates to regulatory and statutory compliance. Specifications and availability subject to change without notice. Not responsible for typographical errors. ©2020 Canon U.S.A., Inc. All rights reserved.

0320RI-IRA4700DXSR5B-PDF-IH



To learn about Canon's many awards, visit [usa.canon.com/awards](http://usa.canon.com/awards).